

### Technical Requirements:

1. Design & Manufacture to: BS 1868
2. Press/Temp to ANSI B16.34
3. Face to face to ANSI B16.10
4. Flange Dimensions to ASME B16.5
5. Test & Inspection to API 598/ISO 5208
6. NACE MR-01-75 (Latest Revision)
7. Conform to Pressure Equipment Directive 2014/68/EU



Class		300LB	
Test Pressure	Shell Test	75	BAR
	High Pressure	55	
	Back Seat		
	Low Pressure		

16	Plug	ASTM A276 410
15	Gasket	ASTM A276 304 St/St
14	Stud Bolt	ASTM A193 B7M
13	Nut	ASTM A194 2HM
12	Eye Bolt	ASTM A29-1035
11	Bonnet	ASTM A216 WCB
10	Gasket	304 St/St - Graphite
9	Name Plate	304 St/St
8	Rivet	304 St/St
7	Pin	ASTM A276-410
6	Nut	ASTM A276-410
5	Washer	ASTM A276-410
4	Hinge	ASTM A216 WCB
3	Disc	A105 + F6 13% Chr
2	Seat	A105 + Stellite
1	Body	ASTM A216 WCB
Pos	PART NAMES:	MATERIALS:

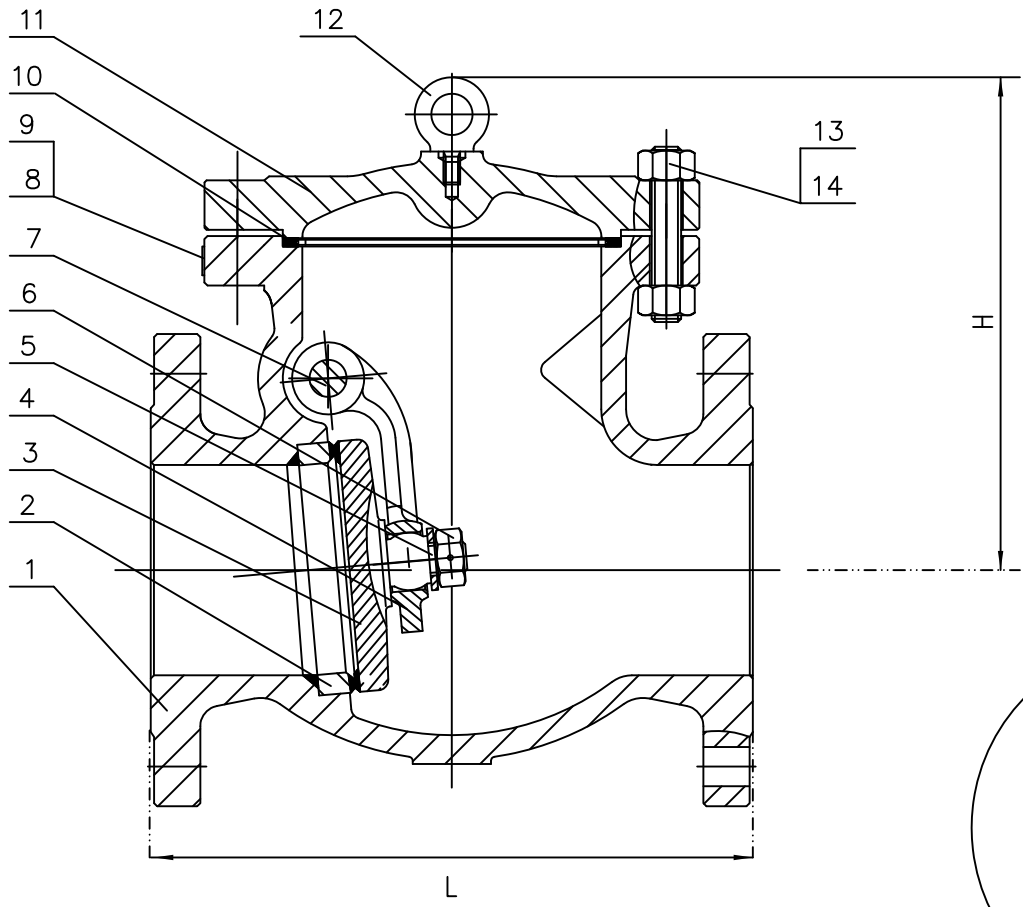
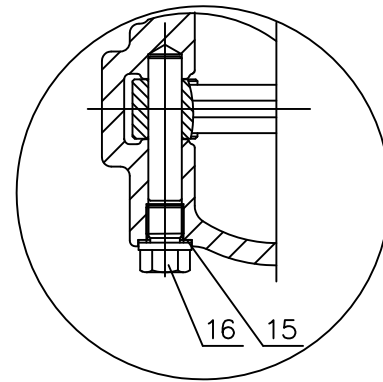

Size (Inch)	2"	2 1/2"	3"	4"	6"	8"	10"	12"	14"	16"	18"	20"	24"	CL300 Swing Check Valve Bolted Cover	
L(RF)(BW)	267	292	318	356	444	533	622	711	838	864	978	1016	1346	Issue No	REV 3
L(RTJ)	283	308	333	371	460	549	638	727	854	879	994	1035	1368		
H (Approx)	167	185	210	281	323	399	440	462	571	659	676	742	810	Fig No	CKC300
Weight	(RF) 23	(RF) 37	(RF) 46	(RF) 70	(RF) 125	(RF) 202	(RF) 296	(RF) 450	(RF) 585	(RF) 764	(RF) 936	(RF) 1165	(RF) 1418		
	(BW) 17	(BW) 29	(BW) 37	(BW) 44	(BW) 98	(BW) 163	(BW) 237	(BW) 375	(BW) 463	(BW) 630	(BW) 789	(BW) 989	(BW) 1286		